

**Features**

**Benefits**

1	Superior front horizontal rail.	Additional rigidity. Impurity prevention.
2	Removable front center post.	Full flexibility for all door and drawer arrangements.
3	The front posts can accommodate varying arrangements of doors & drawers.	Flexibility even after installation
4	Wrap-around cabinet shell construction.	Provides maximum strength and eliminates need for a fixed finished back.
5	Removable back panel.	Allows accessibility to mechanical services.
6	Slotted rear post.	Support for slide arms and shelves. Full flexibility for future needs.
7	Cabinet body is fully enclosed.	Facilitating maintenance and cleaning.
8	Extended drawer depth.	Maximized storage capacity.
9	Insulated facades.	The doors and drawer fronts are made of 3/4 « thick clear maple wood.
10	Self-closing ball bearing slide arms.	Avoiding accidental spills.
11	Threaded 5/16" leveler with large foot.	Solid, sturdy and prevents scratching.
12	Various standard handles.	Adhere to design intent.

## Forte Flush Overlay Door/Drawer Combination Possibilities

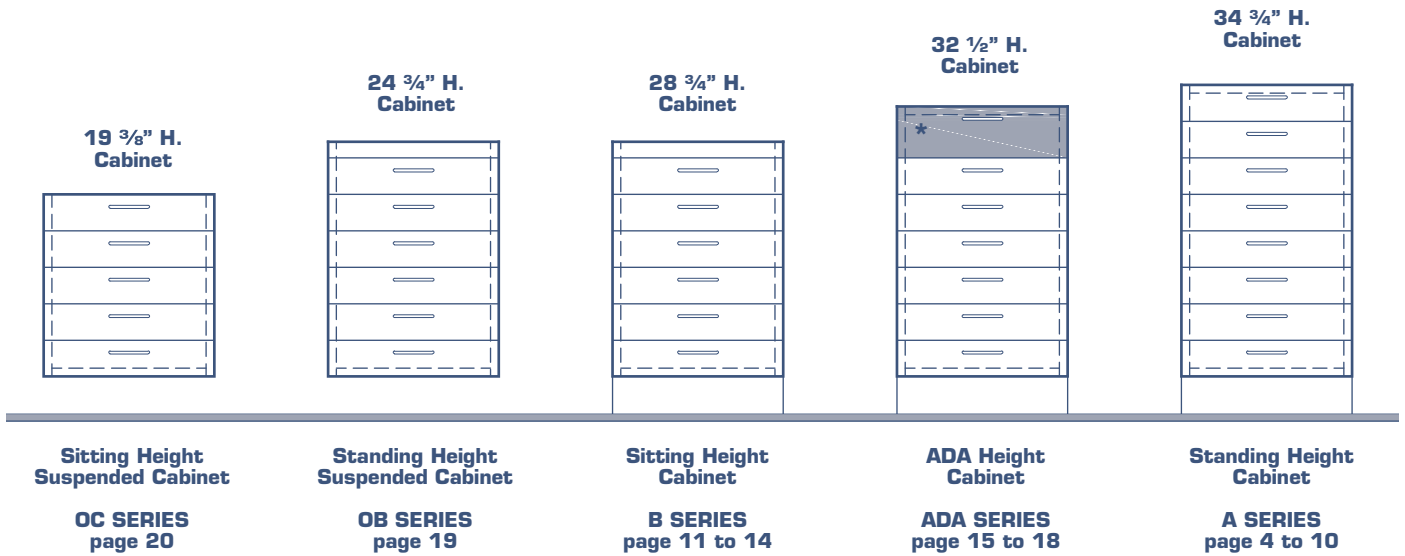

Our cabinet design is engineered for interchangeability of the same drawer and door heights for all different cabinet types including the following drawer and door heights:

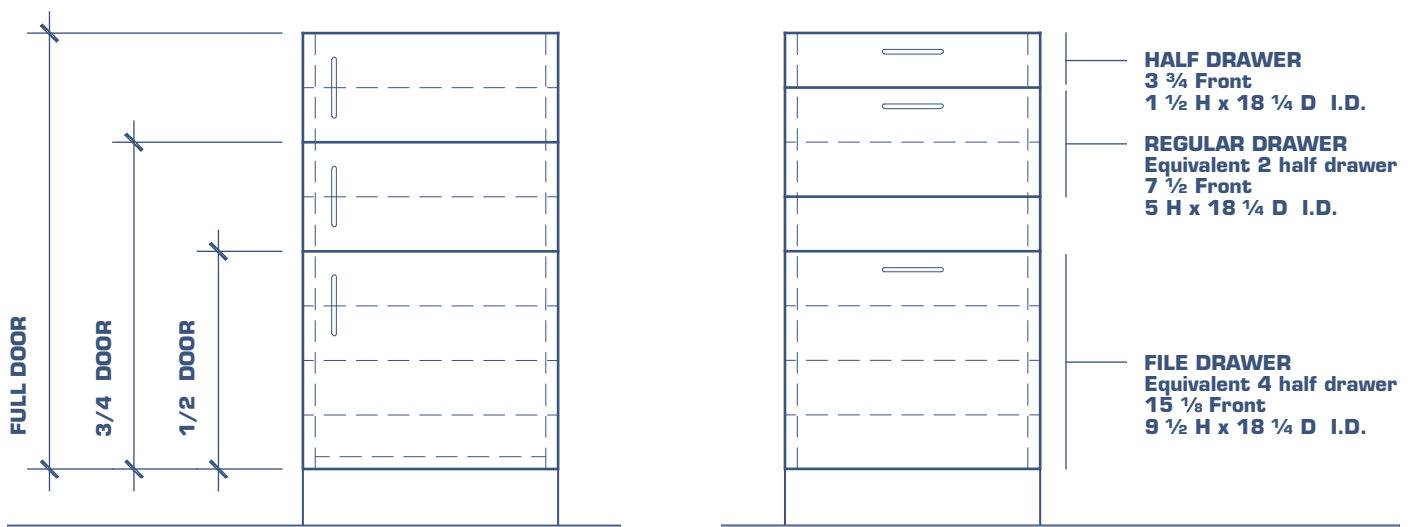

\* The top drawer and full height door on an ADA cabinet are of different heights than for all other cabinets and will only fit at this position.

## Reading the product identification numbers code

The Bedcolab product identification number is simple, making it easy to verify that you have ordered the correct cabinet. Each number or letter in the designation represents an aspect of the cabinet. Below are examples of the product identification numbers you will see in this catalogue along with an explanation of each designation:

### Product Identification Code

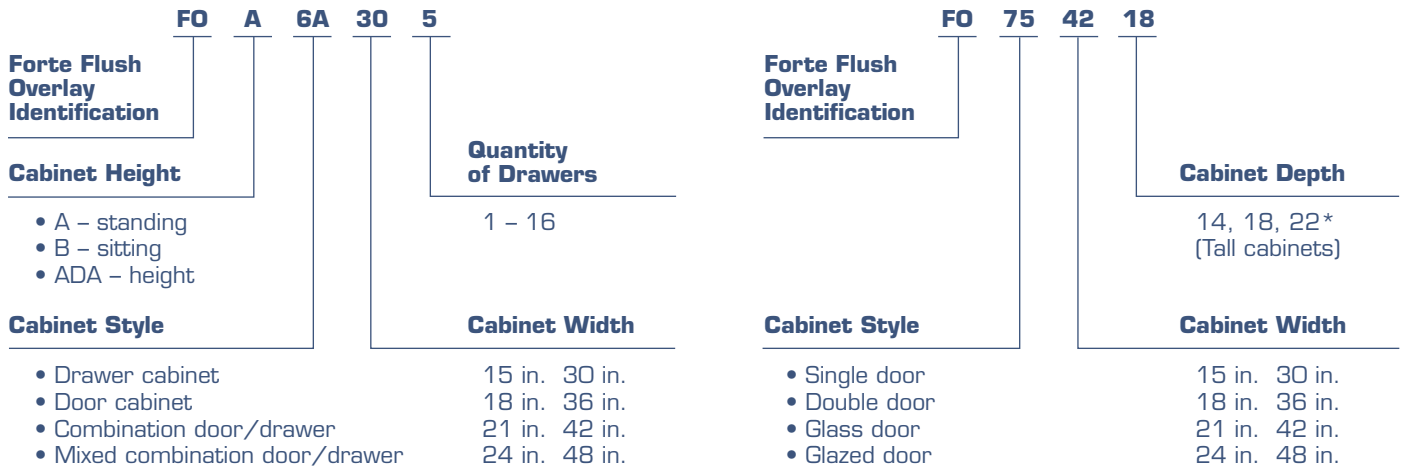

#### Base cabinets

#### Wall and Tall cabinets

Please refer to page 29 of this Forte Flush Overlay catalogue for hardware options and optional cabinet features.

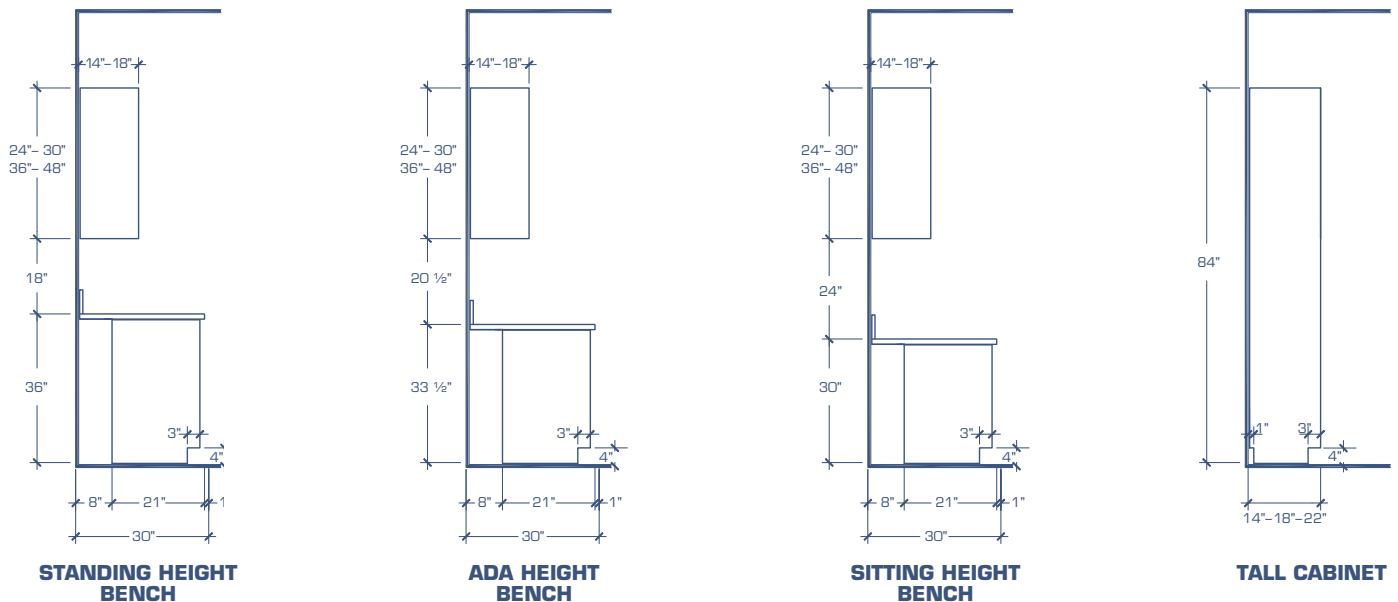

Typical Side Views

# Standing Height Base Cabinets

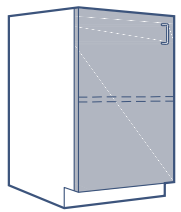

Model no.	Width	
	inches	mm
FO-A1-15	15	381
FO-A1-18	18	457
FO-A1-21	21	533
FO-A1-24	24	610

**1 door unit**

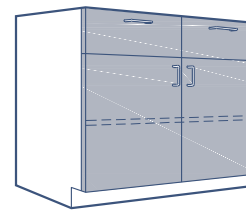

Model no.	Width	
	inches	mm
FO-A5-30-2	30	762
FO-A5-36-2	36	914
FO-A5-42-2	42	1067
FO-A5-48-2	48	1219

**2 drawer & 2 door unit**

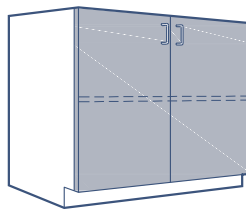

FO-A2-30	30	762
FO-A2-36	36	914
FO-A2-42	42	1067
FO-A2-48	48	1219

**2 door unit**

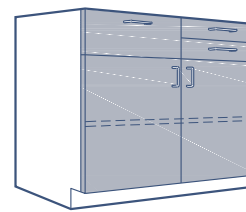

FO-A5-30-3	30	762
FO-A5-36-3	36	914
FO-A5-42-3	42	1067
FO-A5-48-3	48	1219

**2 half drawer, 1 drawer & 2 door unit**

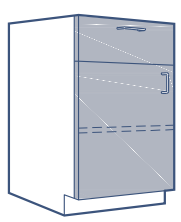

FO-A4-15-1	15	381
FO-A4-18-1	18	457
FO-A4-21-1	21	533
FO-A4-24-1	24	610

**1 drawer - 1 door unit**

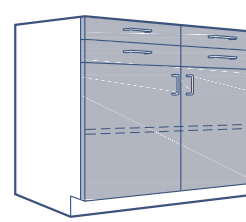

FO-A5-30-4	30	762
FO-A5-36-4	36	914
FO-A5-42-4	42	1067
FO-A5-48-4	48	1219

**4 half drawer & 2 door unit**

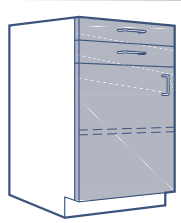

FO-A4-15-2	15	381
FO-A4-18-2	18	457
FO-A4-21-2	21	533
FO-A4-24-2	24	610

**2 half drawer & 1 door unit**

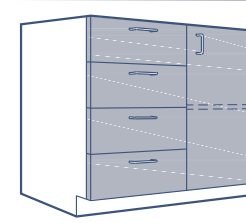

FO-A6-30-4	30	762
FO-A6-36-4	36	914
FO-A6-42-4	42	1067
FO-A6-48-4	48	1219

**4 drawer & 1 door unit**

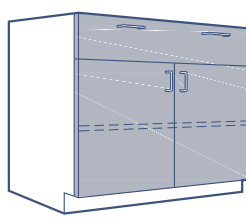

FO-A5-30-1	30	762
FO-A5-36-1	36	914
FO-A5-42-1 *3	42	1067
FO-A5-48-1 *3	48	1219

**1 drawer & 2 door unit**

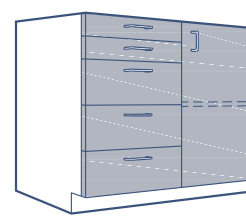

FO-A6-30-5	30	762
FO-A6-36-5	36	914
FO-A6-42-5	42	1067
FO-A6-48-5	48	1219

**2 half drawer, 3 drawer & 1 door unit**

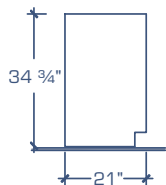

**Legend:**

- \*1 Double pulls on 30" to 48" cabinet sizes
- \*2 File drawers supplied with hanger bars and full extension slide arms to fit legal or letter size files
- \*3 Full extension drawer slide arms supplied as standard on these cabinets
- \*4 Back panels in these cabinets are 9" high

Reverse models are also available by adding "RV" to model number.

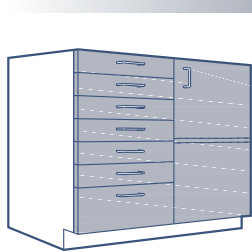

Model no.	Width	
	inches	mm
FO-A6-30-7	30	762
FO-A6-36-7	36	914
FO-A6-42-7	42	1067
FO-A6-48-7	48	1219

**6 half drawer, 1 drawer & 1 door unit**

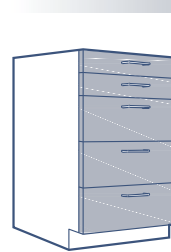

Model no.	Width	
	inches	mm
FO-A7-15-5	15	381
FO-A7-18-5	18	457
FO-A7-21-5	21	533
FO-A7-24-5	24	610
FO-A7-30-5 *1	30	762
FO-A7-36-5 *1	36	914
FO-A7-42-5 *1*3	42	1067
FO-A7-48-5 *1*3	48	1219

**2 half drawer & 3 drawer unit**

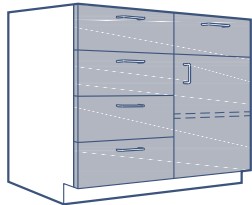

FO-A6A-30-5	30	762
FO-A6A-36-5	36	914
FO-A6A-42-5	42	1067
FO-A6A-48-5	48	1219

**5 drawer & 1 door unit**

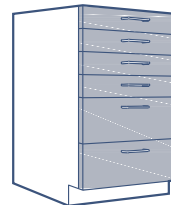

FO-A7-15-6	15	381
FO-A7-18-6	18	457
FO-A7-21-6	21	533
FO-A7-24-6	24	610
FO-A7-30-6 *1	30	762
FO-A7-36-6 *1	36	914
FO-A7-42-6 *1*3	42	1067
FO-A7-48-6 *1*3	48	1219

**4 half drawer & 2 drawer unit**

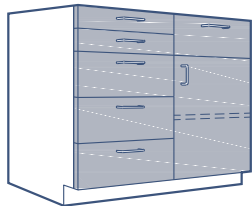

FO-A6A-30-6	30	762
FO-A6A-36-6	36	914
FO-A6A-42-6	42	1067
FO-A6A-48-6	48	1219

**2 half drawer, 4 drawer & 1 door unit**

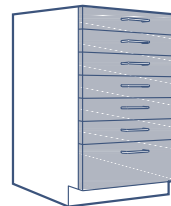

FO-A7-15-7	15	381
FO-A7-18-7	18	457
FO-A7-21-7	21	533
FO-A7-24-7	24	610
FO-A7-30-7 *1	30	762
FO-A7-36-7 *1	36	914
FO-A7-42-7 *1*3	42	1067
FO-A7-48-7 *1*3	48	1219

**6 half drawer & 1 drawer unit**

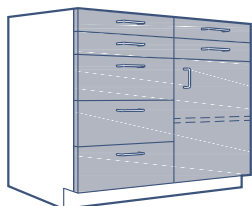

FO-A6A-30-7	30	762
FO-A6A-36-7	36	914
FO-A6A-42-7	42	1067
FO-A6A-48-7	48	1219

**4 half drawer, 3 drawer & 1 door unit**

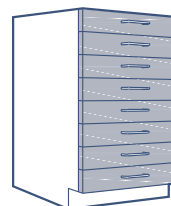

FO-A7-15-8	15	381
FO-A7-18-8	18	457
FO-A7-21-8	21	533
FO-A7-24-8	24	610
FO-A7-30-8 *1	30	762
FO-A7-36-8 *1	36	914
FO-A7-42-8 *1*3	42	1067
FO-A7-48-8 *1*3	48	1219

**8 half drawer unit**

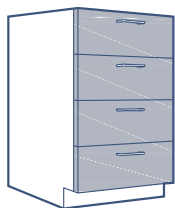

FO-A7-15-4	15	381
FO-A7-18-4	18	457
FO-A7-21-4	21	533
FO-A7-24-4	24	610
FO-A7-30-4 *1	30	762
FO-A7-36-4 *1	36	914
FO-A7-42-4 *1*3	42	1067
FO-A7-48-4 *1*3	48	1219

**4 drawer unit**

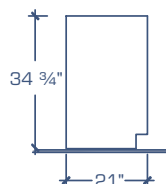

**Legend:**

- \*1 Double pulls on 30" to 48" cabinet sizes
- \*2 File drawers supplied with hanger bars and full extension slide arms to fit legal or letter size files
- \*3 Full extension drawer slide arms supplied as standard on these cabinets
- \*4 Back panels in these cabinets are 9" high

Reverse models are also available by adding "RV" to model number.

Standing Height Base Cabinets

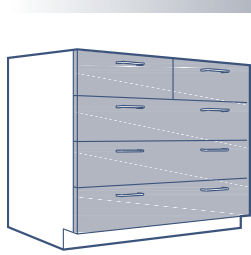

Model no.	Width	
	inches	mm
FO-A8-30-5 *1	30	762
FO-A8-36-5 *1	36	914
FO-A8-42-5 *1*3	42	1067
FO-A8-48-5 *1*3	48	1219

5 drawer unit

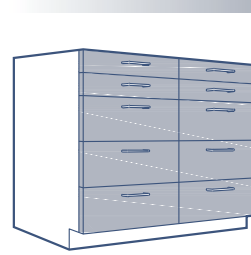

Model no.	Width	
	inches	mm
FO-A10-30-10	30	762
FO-A10-36-10	36	914
FO-A10-42-10	42	1067
FO-A10-48-10	48	1219

4 half drawer & 6 drawer unit

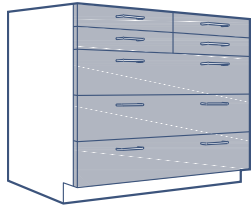

FO-A8-30-7 *1	30	762
FO-A8-36-7 *1	36	914
FO-A8-42-7 *1*3	42	1067
FO-A8-48-7 *1*3	48	1219

4 half drawer & 3 drawer unit

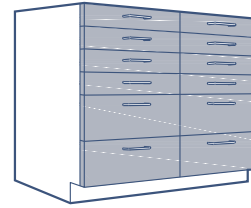

FO-A10-30-12	30	762
FO-A10-36-12	36	914
FO-A10-42-12	42	1067
FO-A10-48-12	48	1219

8 half drawer & 4 drawer unit

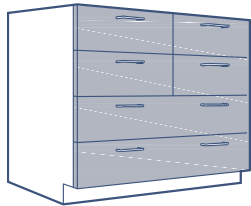

FO-A9-30-6 *1	30	762
FO-A9-36-6 *1	36	914
FO-A9-42-6 *1*3	42	1067
FO-A9-48-6 *1*3	48	1219

6 drawer unit

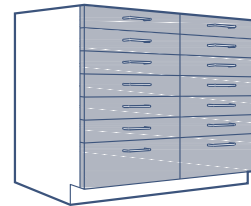

FO-A10-30-14	30	762
FO-A10-36-14	36	914
FO-A10-42-14	42	1067
FO-A10-48-14	48	1219

12 half drawer & 2 drawer unit

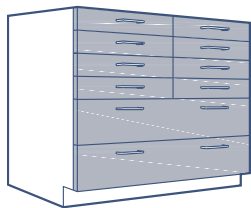

FO-A9-30-10 *1	30	762
FO-A9-36-10 *1	36	914
FO-A9-42-10 *1*3	42	1067
FO-A9-48-10 *1*3	48	1219

8 half drawer & 2 drawer unit

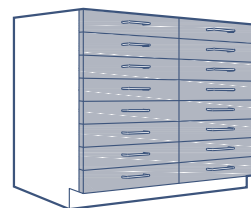

FO-A10-30-16	30	762
FO-A10-36-16	36	914
FO-A10-42-16	42	1067
FO-A10-48-16	48	1219

16 half drawer unit

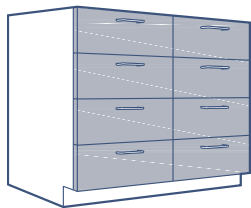

FO-A10-30-8	30	762
FO-A10-36-8	36	914
FO-A10-42-8	42	1067
FO-A10-48-8	48	1219

8 drawer unit

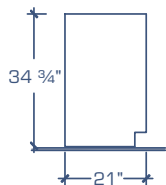

Legend:

- \*1 Double pulls on 30" to 48" cabinet sizes
- \*2 File drawers supplied with hanger bars and full extension slide arms to fit legal or letter size files
- \*3 Full extension drawer slide arms supplied as standard on these cabinets
- \*4 Back panels in these cabinets are 9" high

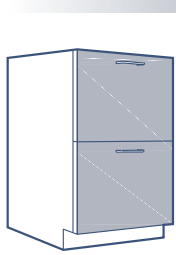

Model no.	Width	
	inches	mm
FO-A11-15-2 *2	15	381
FO-A11-18-2 *2	18	457
FO-A11-21-2 *2	21	533
FO-A11-24-2 *2	24	610

**2 file drawer unit**

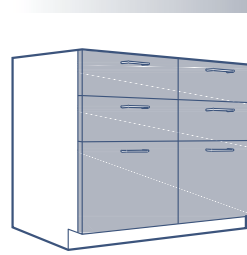

Model no.	Width	
	inches	mm
FO-A11-30-6 *2	30	762
FO-A11-36-6 *2	36	914
FO-A11-42-6 *2	42	1067
FO-A11-48-6 *2	48	1219

**4 drawer & 2 file drawer unit**

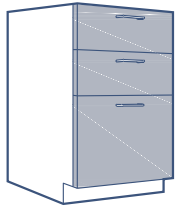

FO-A11-15-3 *2	15	381
FO-A11-18-3 *2	18	457
FO-A11-21-3 *2	21	533
FO-A11-24-3 *2	24	610

**2 drawer & 1 file drawer unit**

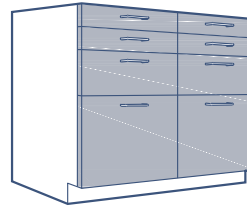

FO-A11-30-8 *2	30	762
FO-A11-36-8 *2	36	914
FO-A11-42-8 *2	42	1067
FO-A11-48-8 *2	48	1219

**4 half drawer, 2 drawer & 2 file drawer unit**

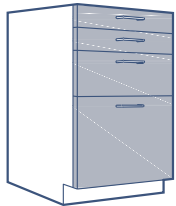

FO-A11-15-4 *2	15	381
FO-A11-18-4 *2	18	457
FO-A11-21-4 *2	21	533
FO-A11-24-4 *2	24	610

**2 half drawer, 1 drawer & 1 file drawer unit**

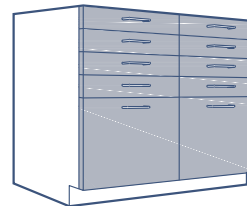

FO-A11-30-10 *2	30	762
FO-A11-36-10 *2	36	914
FO-A11-42-10 *2	42	1067
FO-A11-48-10 *2	48	1219

**8 half drawer & 2 file drawer unit**

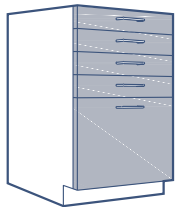

FO-A11-15-5 *2	15	381
FO-A11-18-5 *2	18	457
FO-A11-21-5 *2	21	533
FO-A11-24-5 *2	24	610

**4 half drawer & 1 file drawer unit**

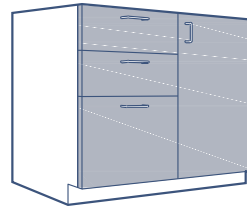

FO-A12-30-3 *2	30	762
FO-A12-36-3 *2	36	914
FO-A12-42-3 *2	42	1067
FO-A12-48-3 *2	48	1219

**2 drawer, 1 file drawer & 1 door unit**

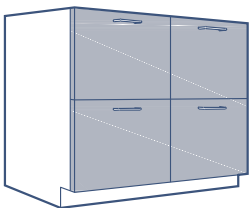

FO-A11-30-4 *2	30	762
FO-A11-36-4 *2	36	914
FO-A11-42-4 *2	42	1067
FO-A11-48-4 *2	48	1219

**4 file drawer unit**

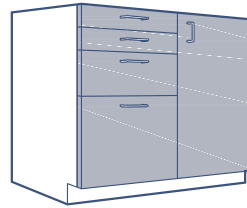

FO-A12-30-4 *2	30	762
FO-A12-36-4 *2	36	914
FO-A12-42-4 *2	42	1067
FO-A12-48-4 *2	48	1219

**2 half drawer, 1 drawer, 1 file drawer & 1 door unit**

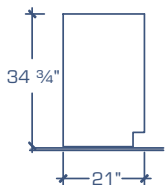

**Legend:**

- \*1 Double pulls on 30" to 48" cabinet sizes
- \*2 File drawers supplied with hanger bars and full extension slide arms to fit legal or letter size files
- \*3 Full extension drawer slide arms supplied as standard on these cabinets
- \*4 Back panels in these cabinets are 9" high

Reverse models are also available by adding "RV" to model number.

Standing Height Base Cabinets

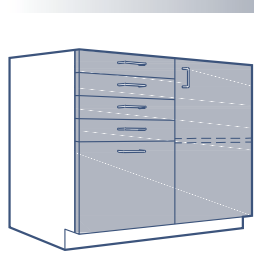

Model no.	Width	
	inches	mm
FO-A12-30-5 *2	30	762
FO-A12-36-5 *2	36	914
FO-A12-42-5 *2	42	1067
FO-A12-48-5 *2	48	1219

4 half drawer, 1 drawer, 1 file drawer & 1 door unit

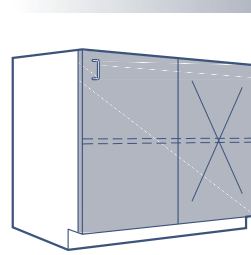

Model no.	Width	
	inches	mm
FO-A20-30	30	762
FO-A20-36	36	914
FO-A20-42	42	1067
FO-A20-48	48	1219

Corner unit

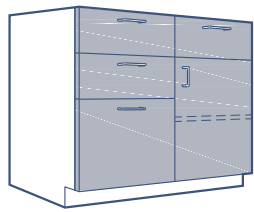

FO-A13-30-4 *2	30	762
FO-A13-36-4 *2	36	914
FO-A13-42-4 *2	42	1067
FO-A13-48-4 *2	48	1219

3 drawer, 1 file drawer & 1 door unit

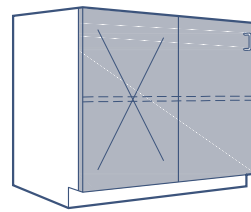

FO-A21-30	30	762
FO-A21-36	36	914
FO-A21-42	42	1067
FO-A21-48	48	1219

Corner unit

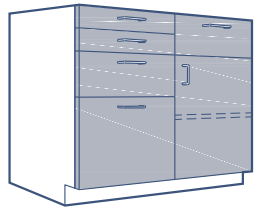

FO-A13-30-5 *2	30	762
FO-A13-36-5 *2	36	914
FO-A13-42-5 *2	42	1067
FO-A13-48-5 *2	48	1219

2 half drawer, 2 drawer, 1 file drawer & 1 door unit

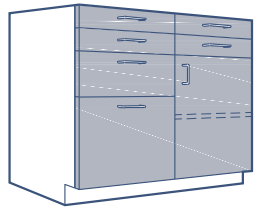

FO-A13-30-6 *2	30	762
FO-A13-36-6 *2	36	914
FO-A13-42-6 *2	42	1067
FO-A13-48-6 *2	48	1219

4 half drawer, 1 drawer, 1 file drawer & 1 door unit

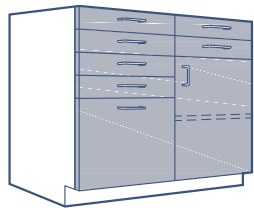

FO-A13-30-7 *2	30	762
FO-A13-36-7 *2	36	914
FO-A13-42-7 *2	42	1067
FO-A13-48-7 *2	48	1219

6 half drawer, 1 file drawer & 1 door unit

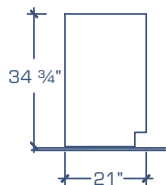

Legend:

- \*1 Double pulls on 30" to 48" cabinet sizes
- \*2 File drawers supplied with hanger bars and full extension slide arms to fit legal or letter size files
- \*3 Full extension drawer slide arms supplied as standard on these cabinets
- \*4 Back panels in these cabinets are 9" high

Reverse models are also available by adding "RV" to model number.



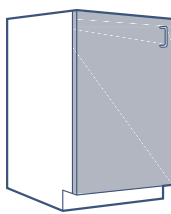

Model no.	Width	
	inches	mm
FO-A15-15 *4	15	381
FO-A15-18 *4	18	457
FO-A15-21 *4	21	533
FO-A15-24 *4	24	610

**1 door sink unit**

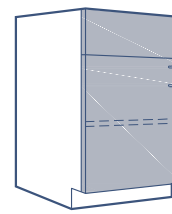

Model no.	Width	
	inches	mm
FO-A24-18	18	457
FO-A24-24	24	610

**Remote control unit - 1 door**

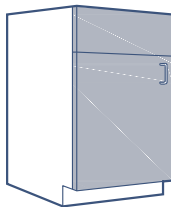

FO-A15A-15 *4	15	381
FO-A15A-18 *4	18	457
FO-A15A-21 *4	21	533
FO-A15A-24 *4	24	610

**1 door sink unit - false panel above**

- Description**
- Fixed upper panel for mounting of services.
  - This unit is mostly used under fume hoods where services are deck mounted.

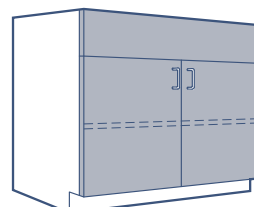

FO-A24-30	30	762
FO-A24-36	36	914
FO-A24-48	48	1219

**Remote control unit - 2 doors**

- Description**
- Fixed upper panel for mounting of services.
  - This unit is mostly used under fume hoods where services are deck mounted.

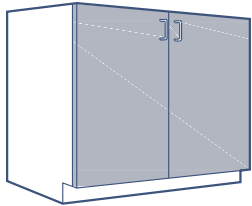

FO-A16-30 *4	30	762
FO-A16-36 *4	36	914
FO-A16-42 *4	42	1067
FO-A16-48 *4	48	1219

**2 door sink unit**

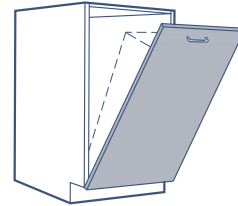

FO-A28-18	18	457
FO-A28-24	24	316

**1 door bin unit**

- Description**
- Bins are not included.
  - Bins can be supplied by adding the following letters after catalog number:
    - "GB" for galvanized steel;
    - "SSB" for stainless steel type 304;
    - For leak proof bin add the letters "LP".

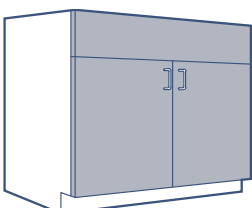

FO-A16A-30 *4	30	762
FO-A16A-36 *4	36	914
FO-A16A-42 *4	42	1067
FO-A16A-48 *4	48	1219

**2 door sink unit - false panel above**

- Description**
- Fixed upper panel for mounting of services.
  - This unit is mostly used under fume hoods where services are deck mounted.



FO-A29-36	36	914
FO-A29-48	48	1219

**2 door bin unit**

- Description**
- Bins are not included.
  - Bins can be supplied by adding the following letters after catalog number:
    - "GB" for galvanized steel;
    - "SSB" for stainless steel type 304;
    - For leak proof bin add the letters "LP".

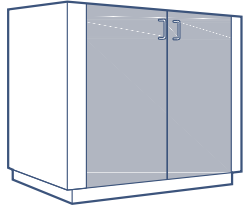

FO-A17-52 *4	52	1321
FO-A17-58 *4	58	1473

**Island end sink unit**

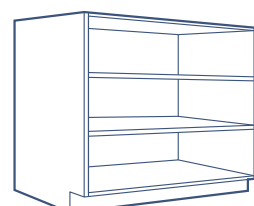

FO-A35-15	15	381
FO-A35-18	18	457
FO-A35-21	21	533
FO-A35-24	24	610
FO-A35-30	30	762
FO-A35-36	36	914
FO-A35-42	42	1067
FO-A35-48	48	1219

**Glassware drying unit**

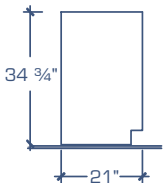

**Legend:**

- \*1 Double pulls on 30" to 48" cabinet sizes
- \*2 File drawers supplied with hanger bars and full extension slide arms to fit legal or letter size files
- \*3 Full extension drawer slide arms supplied as standard on these cabinets
- \*4 Back panels in these cabinets are 9" high

# Sitting Height Base Cabinets

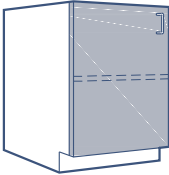

Model no.	Width	
	inches	mm
FO-B1-15	15	381
FO-B1-18	18	457
FO-B1-21	21	533
FO-B1-24	24	610

**1 door unit**

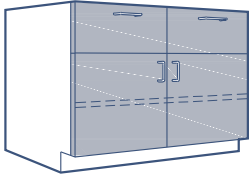

Model no.	Width	
	inches	mm
FO-B5-30-2	30	762
FO-B5-36-2	36	914
FO-B5-42-2	42	1067
FO-B5-48-2	48	1219

**2 drawer & 2 door unit**

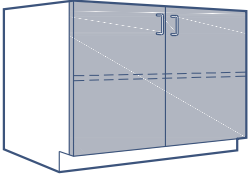

FO-B2-30	30	762
FO-B2-36	36	914
FO-B2-42	42	1067
FO-B2-48	48	1219

**2 door unit**

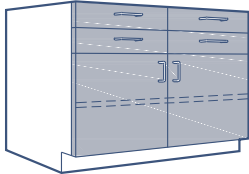

FO-B5-30-4	30	762
FO-B5-36-4	36	914
FO-B5-42-4	42	1067
FO-B5-48-4	48	1219

**4 half drawer & 2 door unit**

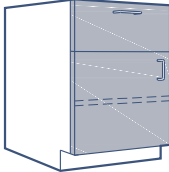

FO-B4-15-1	15	381
FO-B4-18-1	18	457
FO-B4-21-1	21	533
FO-B4-24-1	24	610

**1 drawer & 1 door unit**

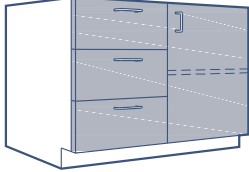

FO-B6-30-3	30	762
FO-B6-36-3	36	914
FO-B6-42-3	42	1067
FO-B6-48-3	48	1219

**3 drawer & 1 door unit**

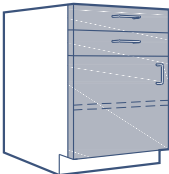

FO-B4-15-2	15	381
FO-B4-18-2	18	457
FO-B4-21-2	21	533
FO-B4-24-2	24	610

**2 half drawer & 1 door unit**

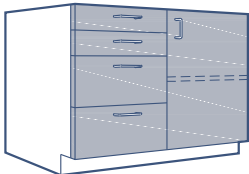

FO-B6-30-4	30	762
FO-B6-36-4	36	914
FO-B6-42-4	42	1067
FO-B6-48-4	48	1219

**2 half drawer, 2 drawer & 1 door unit**

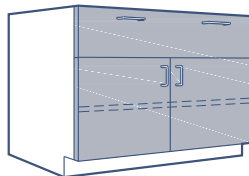

FO-B5-30-1 *1	30	762
FO-B5-36-1 *1	36	914
FO-B5-42-1 *1*3	42	1067
FO-B5-48-1 *1*3	48	1219

**1 drawer & 2 door unit**

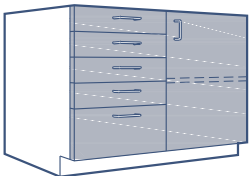

FO-B6-30-5	30	762
FO-B6-36-5	36	914
FO-B6-42-5	42	1067
FO-B6-48-5	48	1219

**4 half drawer, 1 drawer & 1 door unit**

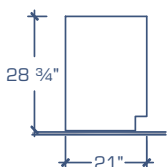

**Legend:**

- \*1 Double pulls on 30" to 48" cabinet sizes
- \*2 File drawers supplied with hanger bars and full extension slide arms to fit legal or letter size files
- \*3 Full extension drawer slide arms supplied as standard on these cabinets
- \*4 Back panels in these cabinets are 9" high

Reverse models are also available by adding "RV" to model number.

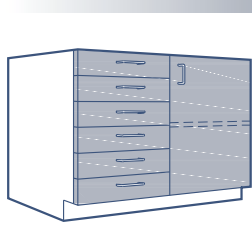

Model no.	Width	
	inches	mm
FO-B6-30-6	30	762
FO-B6-36-6	36	914
FO-B6-42-6	42	1067
FO-B6-48-6	48	1219

6 half drawer & 1 door unit

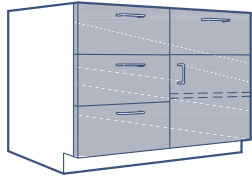

Model no.	Width	
	inches	mm
FO-B6A-30-4	30	762
FO-B6A-36-4	36	914
FO-B6A-42-4	42	1067
FO-B6A-48-4	48	1219

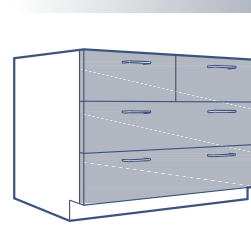

Model no.	Width	
	inches	mm
FO-B8-30-4 *1	30	762
FO-B8-36-4 *1	36	914
FO-B8-42-4 *1*3	42	1067
FO-B8-48-4 *1*3	48	1219

4 drawer unit

4 drawer & 1 door unit

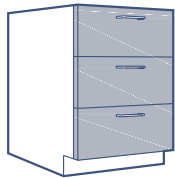

FO-B7-15-3	15	381
FO-B7-18-3	18	457
FO-B7-21-3	21	533
FO-B7-24-3	24	610
FO-B7-30-3 *1	30	762
FO-B7-36-3 *1	36	914
FO-B7-42-3 *1*3	42	1067
FO-B7-48-3 *1*3	48	1219

3 drawer unit

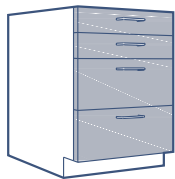

FO-B7-15-4	15	381
FO-B7-18-4	18	457
FO-B7-21-4	21	533
FO-B7-24-4	24	610
FO-B7-30-4 *1	30	762
FO-B7-36-4 *1	36	914
FO-B7-42-4 *1*3	42	1067
FO-B7-48-4 *1*3	48	1219

2 half drawer & 2 drawer unit

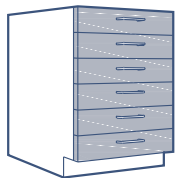

FO-B7-15-6	15	381
FO-B7-18-6	18	457
FO-B7-21-6	21	533
FO-B7-24-6	24	610
FO-B7-30-6 *1	30	762
FO-B7-36-6 *1	36	914
FO-B7-42-6 *1*3	42	1067
FO-B7-48-6 *1*3	48	1219

6 half drawer unit

4 half drawer & 2 drawer unit

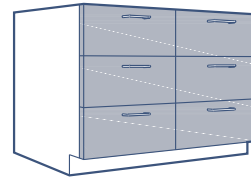

FO-B10-30-6	30	762
FO-B10-36-6	36	914
FO-B10-42-6	42	1067
FO-B10-48-6	48	1219

6 drawer unit

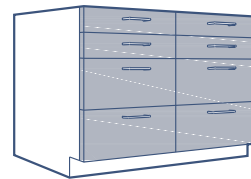

FO-B10-30-8	30	762
FO-B10-36-8	36	914
FO-B10-42-8	42	1067
FO-B10-48-8	48	1219

4 half drawer & 4 drawer unit

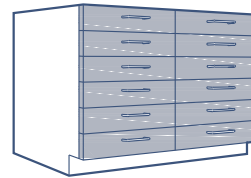

FO-B10-30-12	30	762
FO-B10-36-12	36	914
FO-B10-42-12	42	1067
FO-B10-48-12	48	1219

12 half drawer unit

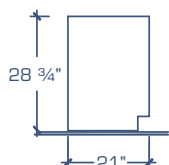

**Legend:**

- \*1 Double pulls on 30" to 48" cabinet sizes
- \*2 File drawers supplied with hanger bars and full extension slide arms to fit legal or letter size files
- \*3 Full extension drawer slide arms supplied as standard on these cabinets
- \*4 Back panels in these cabinets are 9" high

Reverse models are also available by adding "RV" to model number.

Sitting Height Base Cabinets

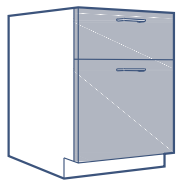

Model no.	Width	
	inches	mm
FO-B11-15-2 *2	15	381
FO-B11-18-2 *2	18	457
FO-B11-21-2 *2	21	533
FO-B11-24-2 *2	24	610

1 drawer & 1 file drawer unit

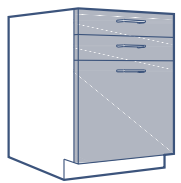

FO-B11-15-3 *2	15	381
FO-B11-18-3 *2	18	457
FO-B11-21-3 *2	21	533
FO-B11-24-3 *2	24	610

2 half drawer & 1 file drawer unit

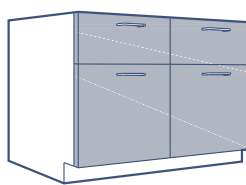

FO-B11-30-4 *2	30	762
FO-B11-36-4 *2	36	914
FO-B11-42-4 *2	42	1067
FO-B11-48-4 *2	48	1219

2 drawer & 2 file drawer unit

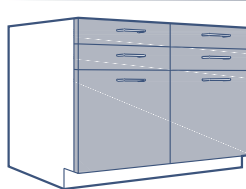

FO-B11-30-6 *2	30	762
FO-B11-36-6 *2	36	914
FO-B11-42-6 *2	42	1067
FO-B11-48-6 *2	48	1219

4 half drawer & 2 file drawer unit

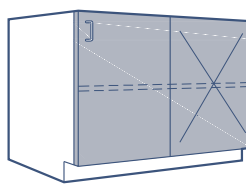

FO-B20-30	30	762
FO-B20-36	36	914
FO-B20-42	42	1067
FO-B20-48	48	1219

Corner unit

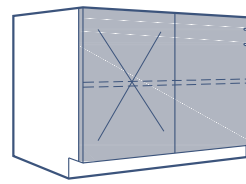

Model no.	Width	
	inches	mm
FO-B21-30	30	762
FO-B21-36	36	914
FO-B21-42	42	1067
FO-B21-48	48	1219

Corner unit

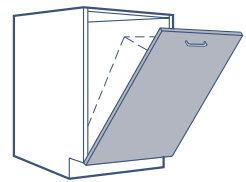

FO-B28-18	18	457
FO-B28-24	24	316

Description

- Bins are not included.
- Bins can be supplied by adding the following letters after catalog number:
  - "GB" for galvanized steel;
  - "SB" for stainless steel T.304;
  - "LP" for leak proof.

1 door bin unit

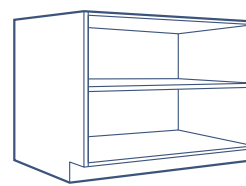

FO-B35-15	15	381
FO-B35-18	18	457
FO-B35-21	21	533
FO-B35-24	24	610
FO-B35-30	30	762
FO-B35-36	36	914
FO-B35-42	42	1067
FO-B35-48	48	1219

Open unit

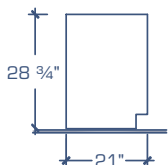

Legend:

- \*1 Double pulls on 30" to 48" cabinet sizes
- \*2 File drawers supplied with hanger bars and full extension slide arms to fit legal or letter size files
- \*3 Full extension drawer slide arms supplied as standard on these cabinets
- \*4 Back panels in these cabinets are 9" high

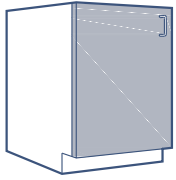

Model no.	Width	
	inches	mm
FO-B15-15 *4	15	381
FO-B15-18 *4	18	457
FO-B15-21 *4	21	533
FO-B15-24 *4	24	610

**1 door sink unit**

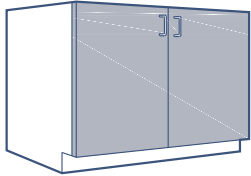

FO-B16-30 *4	30	762
FO-B16-36 *4	36	914
FO-B16-42 *4	42	1067
FO-B16-48 *4	48	1219

**2 door sink unit**

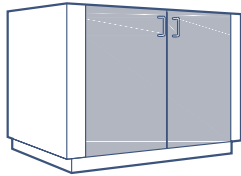

FO-B17-52 *4	52	1321
FO-B17-58 *4	58	1473

**Island end sink unit**

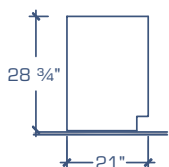

**Legend:**

- \*1 Double pulls on 30" to 48" cabinet sizes
- \*2 File drawers supplied with hanger bars and full extension slide arms to fit legal or letter size files
- \*3 Full extension drawer slide arms supplied as standard on these cabinets
- \*4 Back panels in these cabinets are 9" high

# ADA Height Base Cabinets

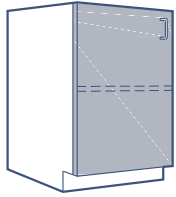

Model no.	Width	
	inches	mm
FO-ADA1-15	15	381
FO-ADA1-18	18	457
FO-ADA1-21	21	533
FO-ADA1-24	24	610

**1 door unit**

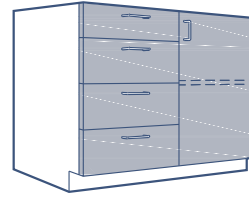

Model no.	Width	
	inches	mm
FO-ADA6-30-4	30	762
FO-ADA6-36-4	36	914
FO-ADA6-42-4	42	1067
FO-ADA6-48-4	48	1219

**3 drawer, 1 top drawer & 1 door unit**

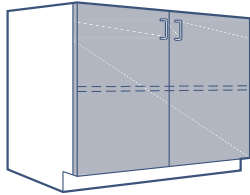

FO-ADA2-30	30	762
FO-ADA2-36	36	914
FO-ADA2-42	42	1067
FO-ADA2-48	48	1219

**2 door unit**

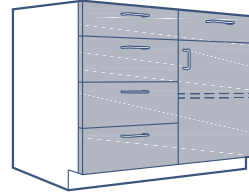

FO-ADA6A-30-5	30	762
FO-ADA6A-36-5	36	914
FO-ADA6A-42-5	42	1067
FO-ADA6A-48-5	48	1219

**3 drawer, 2 top drawer & 1 door unit**

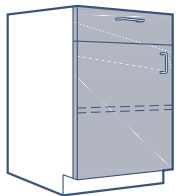

FO-ADA4-15-1	15	381
FO-ADA4-18-1	18	457
FO-ADA4-21-1	21	533
FO-ADA4-24-1	24	610

**1 top drawer & 1 door unit**

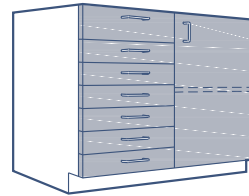

FO-ADA6-30-7	30	762
FO-ADA6-36-7	36	914
FO-ADA6-42-7	42	1067
FO-ADA6-48-7	48	1219

**6 half drawer, 1 top drawer & 1 door unit**

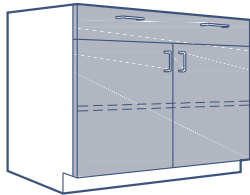

FO-ADA5-30-1	30	762
FO-ADA5-36-1	36	914
FO-ADA5-42-1 *3	42	1067
FO-ADA5-48-1 *3	48	1219

**1 top drawer & 2 door unit**

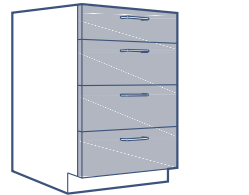

FO-ADA7-15-4	15	381
FO-ADA7-18-4	18	457
FO-ADA7-21-4	21	533
FO-ADA7-24-4	24	610
FO-ADA7-30-4 *1	30	762
FO-ADA7-36-4 *1	36	914
FO-ADA7-42-4 *1*3	42	1067
FO-ADA7-48-4 *1*3	48	1219

**3 drawer & 1 top drawer unit**

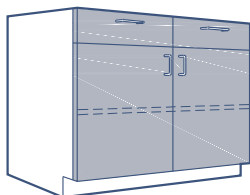

FO-ADA5-30-2	30	762
FO-ADA5-36-2	36	914
FO-ADA5-42-2	42	1067
FO-ADA5-48-2	48	1219

**2 top drawer & 2 door unit**

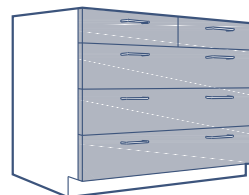

FO-ADA8-30-5	30	762
FO-ADA8-36-5	36	914
FO-ADA8-42-5 *3	42	1067
FO-ADA8-48-5 *3	48	1219

**3 drawer & 2 top drawer unit**

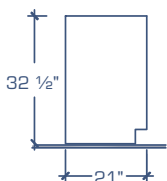

**Legend:**

- \*1 Double pulls on 30" to 48" cabinet sizes
- \*2 File drawers supplied with hanger bars and full extension slide arms to fit legal or letter size files
- \*3 Full extension drawer slide arms supplied as standard on these cabinets
- \*4 Back panels in these cabinets are 9" high

Reverse models are also available by adding "RV" to model number.

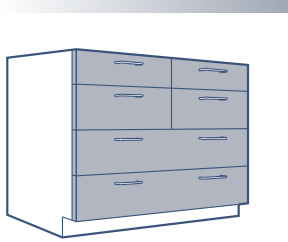

Model no.	Width	
	inches	mm
FO-ADA9-30-6	30	762
FO-ADA9-36-6	36	914
FO-ADA9-42-6 *3	42	1067
FO-ADA9-48-6 *3	48	1219

4 drawer & 2 top drawer unit

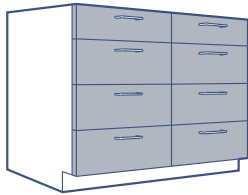

FO-ADA10-30-8	30	762
FO-ADA10-36-8	36	914
FO-ADA10-42-8	42	1067
FO-ADA10-48-8	48	1219

6 drawer & 2 top drawer unit

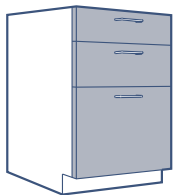

FO-ADA11-15-3 *2	15	381
FO-ADA11-18-3 *2	18	457
FO-ADA11-21-3 *2	21	533
FO-ADA11-24-3 *2	24	610

1 drawer, 1 top drawer & 1 file drawer unit

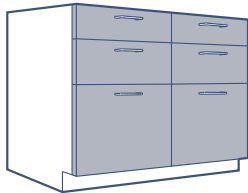

FO-ADA11-30-6 *2	30	762
FO-ADA11-36-6 *2	36	914
FO-ADA11-42-6 *2	42	1067
FO-ADA11-48-6 *2	48	1219

2 drawer, 2 top drawer & 2 file drawer unit

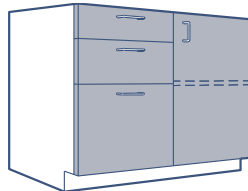

FO-ADA12-30-3 *2	30	762
FO-ADA12-36-3 *2	36	914
FO-ADA12-42-3 *2	42	1067
FO-ADA12-48-3 *2	48	1219

1 drawer, 1 top drawer, 1 file drawer & 1 door unit

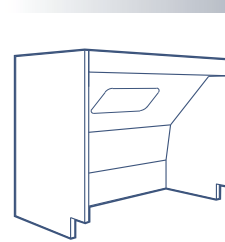

Model no.	Width	
	inches	mm
FO-ADA14-30-LR	30	762
FO-ADA14-36-LR	36	914
FO-ADA14-42-LR	42	1067
FO-ADA14-48-LR	48	1219

Knee Space sink unit w/ 2 sides

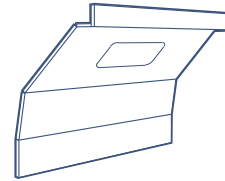

FO-ADA14-30	30	762
FO-ADA14-36	36	914
FO-ADA14-42	42	1067
FO-ADA14-48	48	1219

Knee Space sink unit

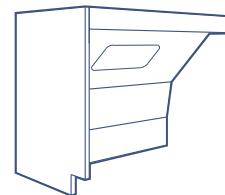

FO-ADA14-30-L	30	762
FO-ADA14-36-L	36	914
FO-ADA14-42-L	42	1067
FO-ADA14-48-L	48	1219

Knee Space sink unit w/ left side

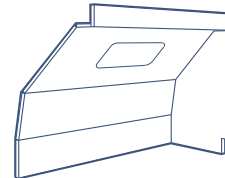

FO-ADA14-30-R	30	762
FO-ADA14-36-R	36	914
FO-ADA14-42-R	42	1067
FO-ADA14-48-R	48	1219

Knee Space sink unit w/ right side

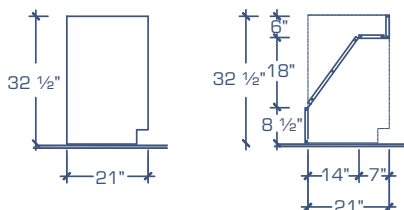

Legend:

- \*1 Double pulls on 30" to 48" cabinet sizes
- \*2 File drawers supplied with hanger bars and full extension slide arms to fit legal or letter size files
- \*3 Full extension drawer slide arms supplied as standard on these cabinets
- \*4 Back panels in these cabinets are 9" high

Reverse models are also available by adding "RV" to model number.

ADA Height Base Cabinets

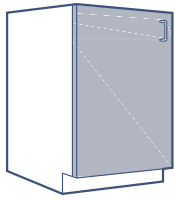

Model no.	Width	
	inches	mm
FO-ADA15-15 *4	15	381
FO-ADA15-18 *4	18	457
FO-ADA15-21 *4	21	533
FO-ADA15-24 *4	24	610

1 door sink unit

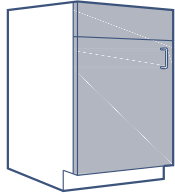

FO-ADA15A-15 *4	15	381
FO-ADA15A-18 *4	18	457
FO-ADA15A-21 *4	21	533
FO-ADA15A-24 *4	24	610

1 door sink unit - false panel above

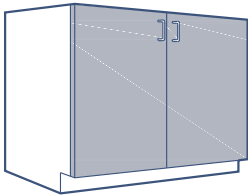

FO-ADA16-30 *4	30	762
FO-ADA16-36 *4	36	914
FO-ADA16-42 *4	42	1067
FO-ADA16-48 *4	48	1219

2 door sink unit

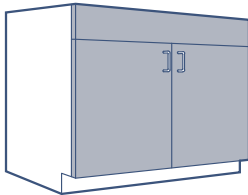

FO-ADA16A-30 *4	30	762
FO-ADA16A-36 *4	36	914
FO-ADA16A-42 *4	42	1067
FO-ADA16A-48 *4	48	1219

2 door sink unit - false panel above

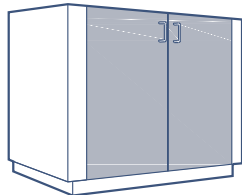

FO-ADA17-52 *4	52	1321
FO-ADA17-58 *4	58	1473

Island end sink unit

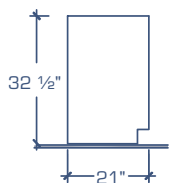

Legend:

- \*1 Double pulls on 30" to 48" cabinet sizes
- \*2 File drawers supplied with hanger bars and full extension slide arms to fit legal or letter size files
- \*3 Full extension drawer slide arms supplied as standard on these cabinets
- \*4 Back panels in these cabinets are 9" high



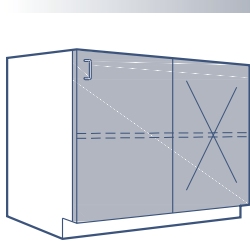

Model no.	Width	
	inches	mm
FO-ADA20-30	30	762
FO-ADA20-36	36	914
FO-ADA20-42	42	1067
FO-ADA20-48	48	1219

Corner unit

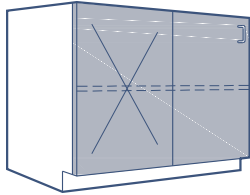

FO-ADA21-30	30	762
FO-ADA21-36	36	914
FO-ADA21-42	42	1067
FO-ADA21-48	48	1219

Corner unit

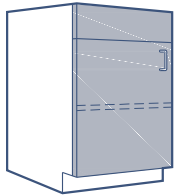

FO-ADA24-18	18	457
FO-ADA24-24	24	610

Remote control unit - 1 door

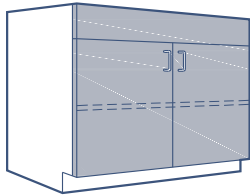

FO-ADA24-30	30	762
FO-ADA24-36	36	914
FO-ADA24-48	48	1219

**Description**

- Fixed upper panel for mounting of services.
- This unit is mostly used under fume hoods where services are deck mounted.

Remote control unit - 2 doors

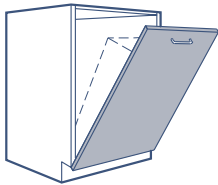

FO-ADA28-18	18	457
FO-ADA28-24	24	316

**Description**

- Bins are not included.
- Bins can be supplied by adding the following letters after catalog number:
  - "GB" for galvanized steel;
  - "SB" for stainless steel T.304;
  - "LP" for leak proof.

1 door bin unit

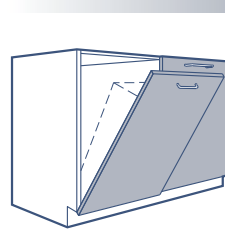

Model no.	Width	
	inches	mm
FO-ADA29-36	36	914
FO-ADA29-48	48	1219

**Description**

- Bins are not included.
- Bins can be supplied by adding the following letters after catalog number:
  - "GB" for galvanized steel;
  - "SB" for stainless steel T.304;
  - "LP" for leak proof.

2 door bin unit

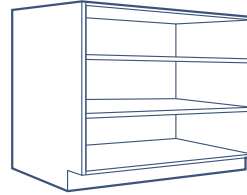

FO-ADA35-15	15	381
FO-ADA35-18	18	457
FO-ADA35-21	21	533
FO-ADA35-24	24	610
FO-ADA35-30	30	762
FO-ADA35-36	36	914
FO-ADA35-42	42	1067
FO-ADA35-48	48	1219

Open unit

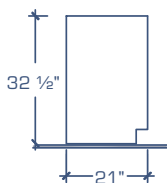

**Legend:**

- \*1 Double pulls on 30" to 48" cabinet sizes
- \*2 File drawers supplied with hanger bars and full extension slide arms to fit legal or letter size files
- \*3 Full extension drawer slide arms supplied as standard on these cabinets
- \*4 Back panels in these cabinets are 9" high

## 24-3/4" High Suspended Cabinets

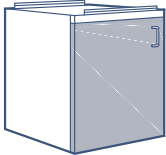

Model no.	Width	
	inches	mm
FO-OB1-15	15	381
FO-OB1-18	18	914
FO-OB1-21	21	1067
FO-OB1-24	24	1219

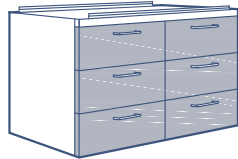

Model no.	Width	
	inches	mm
FO-OB10-30-6	30	752
FO-OB10-36-6	36	914
FO-OB10-42-6	42	1067
FO-OB10-48-6	48	1219

### Suspended 1 Hinged Door Unit



FO-OB2-30	30	752
FO-OB2-36	36	914
FO-OB2-42	42	1067
FO-OB2-48	48	1219

### Suspended 6 Drawer Unit



FO-OB10-30-8	30	752
FO-OB10-36-8	36	914
FO-OB10-42-8	42	1067
FO-OB10-48-8	48	1219

### Suspended 2 Hinged Door unit



FO-OB4-15-1 *2	15	381
FO-OB4-18-1 *2	18	457
FO-OB4-21-1 *2	21	533
FO-OB4-24-1 *2	24	610

### Suspended 4 Half Drawer & 4 Regular Drawer unit

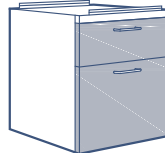

FO-OB11-15-2 *2	15	381
FO-OB11-18-2 *2	18	457
FO-OB11-21-2 *2	21	533
FO-OB11-24-2 *2	24	610

### Suspended 1 Drawer & 1 Hinged Door unit

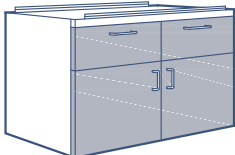

FO-OB5-30-2	30	752
FO-OB5-36-2	36	914
FO-OB5-42-2	42	1067
FO-OB5-48-2	48	1219

### Suspended 1 Drawer & 1 File Drawer unit

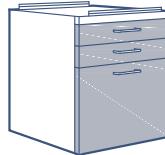

FO-OB11-15-3 *2	15	381
FO-OB11-18-3 *2	18	457
FO-OB11-21-3 *2	21	533
FO-OB11-24-3 *2	24	610

### Suspended 2 Drawer & 2 Hinged Door unit

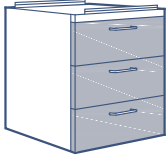

FO-OB7-15-3	15	381
FO-OB7-18-3	18	457
FO-OB7-21-3	21	533
FO-OB7-24-3	24	610
FO-OB7-30-3	30	752
FO-OB7-36-3	36	914
FO-OB7-42-3	42	1067
FO-OB7-48-3	48	1219

### Suspended 2 Half Drawer & 1 File Drawer unit

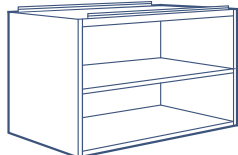

FO-OB35-15	15	381
FO-OB35-18	18	457
FO-OB35-21	21	533
FO-OB35-24	24	610
FO-OB35-30	30	752
FO-OB35-36	36	914
FO-OB35-42	42	1067
FO-OB35-48	48	1219

### Suspended 3 Drawer unit

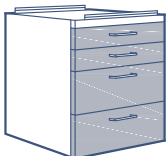

FO-OB7-15-4	15	381
FO-OB7-18-4	18	457
FO-OB7-21-4	21	533
FO-OB7-24-4	24	610
FO-OB7-30-4	30	752
FO-OB7-36-4	36	914
FO-OB7-42-4	42	1067
FO-OB7-48-4	48	1214

### Suspended 2 Half Drawer & 2 Drawer unit

### Suspended Open unit

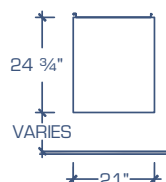

#### Legend:

- \*1 Double pulls on 30" to 48" cabinet sizes
- \*2 File drawers supplied with hanger bars and full extension slide arms to fit legal or letter size files
- \*3 Full extension drawer slide arms supplied as standard on these cabinets
- \*4 Back panels in these cabinets are 9" high

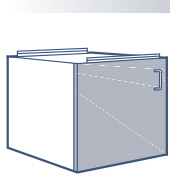

Model no.	Width	
	inches	mm
FO-OC1-15	15	381
FO-OC1-18	18	457
FO-OC1-21	21	533
FO-OC1-24	24	610

**Suspended 1 Hinged Door unit**

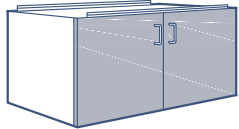

FO-OC2-30	30	762
FO-OC2-36	36	914
FO-OC2-42	42	1067
FO-OC2-48	48	1219

**Suspended 2 Hinged Door unit**

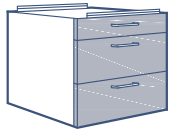

FO-OC7-15-3	15	381
FO-OC7-18-3	18	457
FO-OC7-21-3	21	533
FO-OC7-24-3	24	610

**Suspended 1 Half Drawer & 2 Drawer unit**

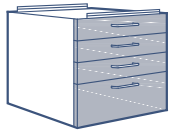

FO-OC10-15-4	15	381
FO-OC10-18-4	18	457
FO-OC10-21-4	21	533
FO-OC10-24-4	24	610

**Suspended 3 Half Drawer & 1 Drawer unit**

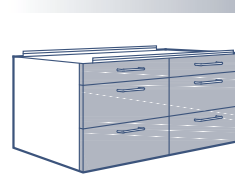

Model no.	Width	
	inches	mm
FO-OC10-30-6	30	762
FO-OC10-36-6	36	914
FO-OC10-42-6	42	1067
FO-OC10-48-6	48	1219

**Suspended 2 Half Drawer & 4 Drawer unit**

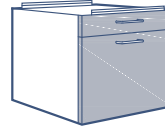

FO-OC11-15-2 *2	15	381
FO-OC11-18-2 *2	18	457
FO-OC11-21-2 *2	21	533
FO-OC11-24-2 *2	24	610

**Suspended 1 Half Drawer + 1 File Drawer unit**

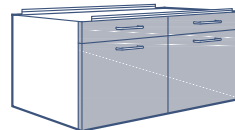

FO-OC11-30-4 *2	30	762
FO-OC11-36-4 *2	36	914
FO-OC11-42-4 *2	42	1067
FO-OC11-48-4 *2	48	1219

**Suspended 2 Half Drawer + 2 File Drawer unit**

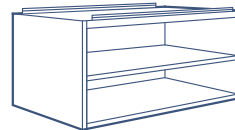

FO-OC35-15	15	381
FO-OC35-18	18	457
FO-OC35-21	21	533
FO-OC35-24	24	610
FO-OC35-30	30	762
FO-OC35-36	36	914
FO-OC35-42	42	1067
FO-OC35-48	48	1219

**Suspended Open unit**

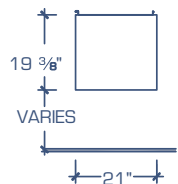

**Legend:**

- \*1 Double pulls on 30" to 48" cabinet sizes
- \*2 File drawers supplied with hanger bars and full extension slide arms to fit legal or letter size files
- \*3 Full extension drawer slide arms supplied as standard on these cabinets
- \*4 Back panels in these cabinets are 9" high

24" High Wall cabinets

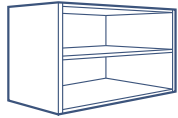

Open shelf unit

Model no.	Width	
	inches	mm
FO-40-15-14	15	381
FO-40-18-14	18	457
FO-40-21-14	21	533
FO-40-24-14	24	610
FO-40-30-14	30	762
FO-40-36-14	36	914
FO-40-42-14	42	1067
FO-40-48-14	48	1219
FO-40-15-18	15	381
FO-40-18-18	18	457
FO-40-21-18	21	533
FO-40-24-18	24	610
FO-40-30-18	30	762
FO-40-36-18	36	914
FO-40-42-18	42	1067
FO-40-48-18	48	1219

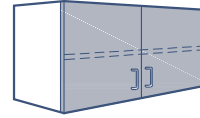

2 hinged door unit

Model no.	Width	
	inches	mm
FO-43-30-14	30	762
FO-43-36-14	36	914
FO-43-42-14	42	1067
FO-43-48-14	48	1219
FO-43-30-18	30	762
FO-43-36-18	36	914
FO-43-42-18	42	1067
FO-43-48-18	48	1219

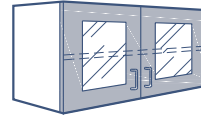

2 glazed hinged door unit

FO-44-30-14	30	762
FO-44-36-14	36	914
FO-44-42-14	42	1067
FO-44-48-14	48	1219
FO-44-30-18	30	762
FO-44-36-18	36	914
FO-44-42-18	42	1067
FO-44-48-18	48	1219

Description

- Unframed glass sliding doors are supplied using 6 mm float glass with finger grooves
- Framed glass doors are supplied using 3 mm float glass

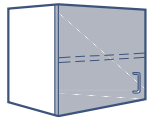

1 hinged door unit

FO-41-15-14	15	381
FO-41-18-14	18	457
FO-41-21-14	21	533
FO-41-24-14	24	610
FO-41-15-18	15	381
FO-41-18-18	18	457
FO-41-21-18	21	533
FO-41-24-18	24	610

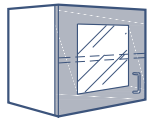

1 glazed hinged door unit

FO-42-15-14	15	381
FO-42-18-14	18	457
FO-42-21-14	21	533
FO-42-24-14	24	610
FO-42-15-18	15	381
FO-42-18-18	18	457
FO-42-21-18	21	533
FO-42-24-18	24	610

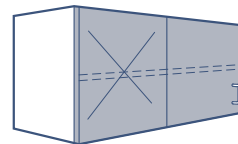

Corner unit with door

FO-10-30-14	30	762
FO-10-36-14	36	914
FO-10-42-14	42	1067
FO-10-48-14	48	1219
FO-10-30-18	30	762
FO-10-36-18	36	914
FO-10-42-18	42	1067
FO-10-48-18	48	1219

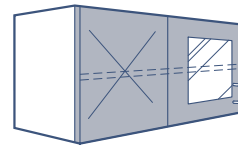

Corner unit with door

FO-20-30-14	30	762
FO-20-36-14	36	914
FO-20-42-14	42	1067
FO-20-48-14	48	1219
FO-20-30-18	30	762
FO-20-36-18	36	914
FO-20-42-18	42	1067
FO-20-48-18	48	1219

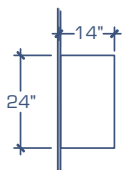

14" depth units

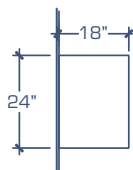

18" depth units

Reverse models are also available by adding "RV" to model number.

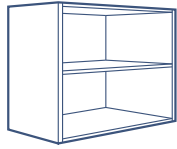

Open shelf unit

Model no.	Width	
	inches	mm
FO-54-15-14	15	381
FO-54-18-14	18	457
FO-54-21-14	21	533
FO-54-24-14	24	610
FO-54-30-14	30	762
FO-54-36-14	36	914
FO-54-42-14	42	1067
FO-54-48-14	48	1219
FO-54-15-18	15	381
FO-54-18-18	18	457
FO-54-21-18	21	533
FO-54-24-18	24	610
FO-54-30-18	30	762
FO-54-36-18	36	914
FO-54-42-18	42	1067
FO-54-48-18	48	1219

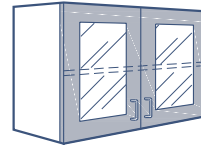

2 glazed hinged door unit

Model no.	Width	
	inches	mm
FO-58-30-14	30	762
FO-58-36-14	36	914
FO-58-42-14	42	1067
FO-58-48-14	48	1219
FO-58-30-18	30	762
FO-58-36-18	36	914
FO-58-42-18	42	1067
FO-58-48-18	48	1219

**Description**

- Unframed glass sliding doors are supplied using 5 mm float glass with finger grooves
- Framed glass doors are supplied using 3 mm float glass

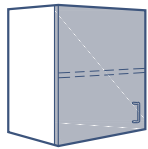

1 hinged door unit

FO-55-15-14	15	381
FO-55-18-14	18	457
FO-55-21-14	21	533
FO-55-24-14	24	610
FO-55-15-18	15	381
FO-55-18-18	18	457
FO-55-21-18	21	533
FO-55-24-18	24	610

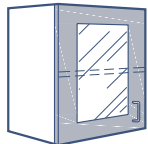

1 glazed hinged door unit

FO-56-15-14	15	381
FO-56-18-14	18	457
FO-56-21-14	21	533
FO-56-24-14	24	610
FO-56-15-18	15	381
FO-56-18-18	18	457
FO-56-21-18	21	533
FO-56-24-18	24	610

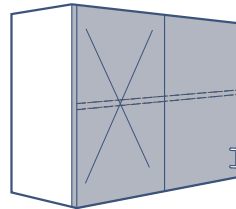

Corner unit with door

FO-11-30-14	30	762
FO-11-36-14	36	914
FO-11-42-14	42	1067
FO-11-48-14	48	1219
FO-11-30-18	30	762
FO-11-36-18	36	914
FO-11-42-18	42	1067
FO-11-48-18	48	1219

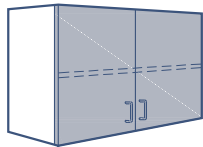

2 hinged door unit

FO-57-30-14	30	762
FO-57-36-14	36	914
FO-57-42-14	42	1067
FO-57-48-14	48	1219
FO-57-30-18	30	762
FO-57-36-18	36	914
FO-57-42-18	42	1067
FO-57-48-18	48	1219

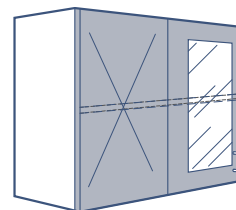

Corner unit with glazed door

FO-21-30-14	30	762
FO-21-36-14	36	914
FO-21-42-14	42	1067
FO-21-48-14	48	1219
FO-21-30-18	30	762
FO-21-36-18	36	914
FO-21-42-18	42	1067
FO-21-48-18	48	1219

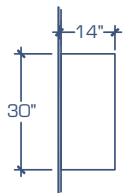

14" depth units

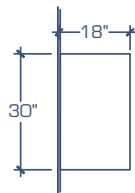

18" depth units

Reverse models are also available by adding "RV" to model number.

36" High Wall Cabinets



Open shelf unit

Model no.	Width	
	inches	mm
FO-63-15-14	15	381
FO-63-18-14	18	457
FO-63-21-14	21	533
FO-63-24-14	24	610
FO-63-30-14	30	762
FO-63-36-14	36	914
FO-63-42-14	42	1067
FO-63-48-14	48	1219
FO-63-15-18	15	381
FO-63-18-18	18	457
FO-63-21-18	21	533
FO-63-24-18	24	610
FO-63-30-18	30	762
FO-63-36-18	36	914
FO-63-42-18	42	1067
FO-63-48-18	48	1219

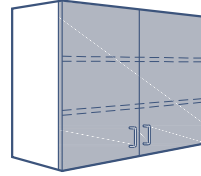

2 solid hinged door unit

Model no.	Width	
	inches	mm
FO-66-30-14	30	762
FO-66-36-14	36	914
FO-66-42-14	42	1067
FO-66-48-14	48	1219
FO-66-30-18	30	762
FO-66-36-18	36	914
FO-66-42-18	42	1067
FO-66-48-18	48	1219

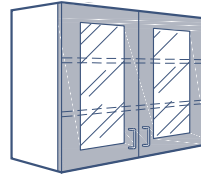

2 glazed hinged door unit

FO-67-30-14	30	762
FO-67-36-14	36	914
FO-67-42-14	42	1067
FO-67-48-14	48	1219
FO-67-30-18	30	762
FO-67-36-18	36	914
FO-67-42-18	42	1067
FO-67-48-18	48	1219

Description

- Unframed glass sliding doors are supplied using 5 mm float glass with finger grooves
- Framed glass doors are supplied using 3 mm float glass

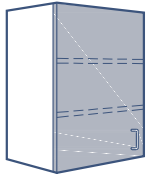

1 hinged door unit

FO-64-15-14	15	381
FO-64-18-14	18	457
FO-64-21-14	21	533
FO-64-24-14	24	610
FO-64-15-18	15	381
FO-64-18-18	18	457
FO-64-21-18	21	533
FO-64-24-18	24	610

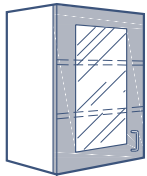

1 glazed hinged door unit

FO-65-15-14	15	381
FO-65-18-14	18	457
FO-65-21-14	21	533
FO-65-24-14	24	610
FO-65-15-18	15	381
FO-65-18-18	18	457
FO-65-21-18	21	533
FO-65-24-18	24	610

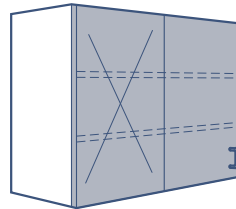

Corner unit with door

FO-12-30-14	30	762
FO-12-36-14	36	914
FO-12-42-14	42	1067
FO-12-48-14	48	1219
FO-12-30-18	30	762
FO-12-36-18	36	914
FO-12-42-18	42	1067
FO-12-48-18	48	1219

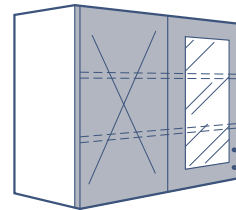

Corner unit with door

FO-22-30-14	30	762
FO-22-36-14	36	914
FO-22-42-14	42	1067
FO-22-48-14	48	1219
FO-22-30-18	30	762
FO-22-36-18	36	914
FO-22-42-18	42	1067
FO-22-48-18	48	1219

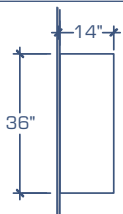

14" depth units

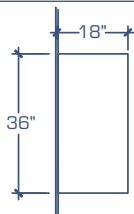

18" depth units

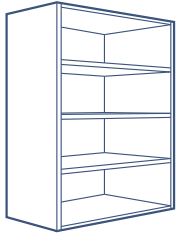

Open shelf unit

Model no.	Width	
	inches	mm
FO-72-15-14	15	381
FO-72-18-14	18	457
FO-72-21-14	21	533
FO-72-24-14	24	610
FO-72-30-14	30	762
FO-72-36-14	36	914
FO-72-42-14	42	1067
FO-72-48-14	48	1219
FO-72-15-18	15	381
FO-72-18-18	18	457
FO-72-21-18	21	533
FO-72-24-18	24	610
FO-72-30-18	30	762
FO-72-36-18	36	914
FO-72-42-18	42	1067
FO-72-48-18	48	1219

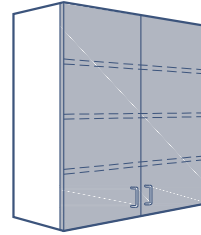

2 hinged door unit

Model no.	Width	
	inches	mm
FO-75-30-14	30	762
FO-75-36-14	36	914
FO-75-42-14	42	1067
FO-75-48-14	48	1219
FO-75-30-18	30	762
FO-75-36-18	36	914
FO-75-42-18	42	1067
FO-75-48-18	48	1219

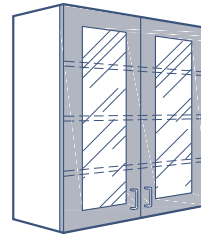

2 glazed hinged door unit

FO-76-30-14	30	762
FO-76-36-14	36	914
FO-76-42-14	42	1067
FO-76-48-14	48	1219
FO-76-30-18	30	762
FO-76-36-18	36	914
FO-76-42-18	42	1067
FO-76-48-18	48	1219

**Description**

- Unframed glass sliding doors are supplied using 5 mm float glass with finger grooves
- Framed glass doors are supplied using 3 mm float glass

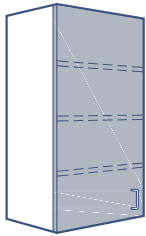

1 hinged door unit

FO-73-15-14	15	381
FO-73-18-14	18	457
FO-73-21-14	21	533
FO-73-24-14	24	610
FO-73-15-18	15	381
FO-73-18-18	18	457
FO-73-21-18	21	533
FO-73-24-18	24	610

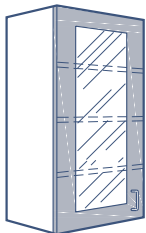

1 glazed hinged door unit

FO-74-15-14	15	381
FO-74-18-14	18	457
FO-74-21-14	21	533
FO-74-24-14	24	610
FO-74-15-18	15	381
FO-74-18-18	18	457
FO-74-21-18	21	533
FO-74-24-18	24	610

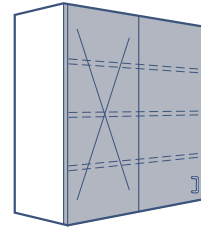

Corner unit - with door 48"

FO-13-30-14	30	762
FO-13-36-14	36	914
FO-13-42-14	42	1067
FO-13-48-14	48	1219
FO-13-30-18	30	762
FO-13-36-18	36	914
FO-13-42-18	42	1067
FO-13-48-18	48	1219

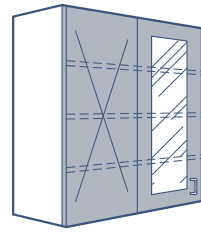

Corner unit - with glazed door 48"

FO-23-30-14	30	762
FO-23-36-14	36	914
FO-23-42-14	42	1067
FO-23-48-14	48	1219
FO-23-30-18	30	762
FO-23-36-18	36	914
FO-23-42-18	42	1067
FO-23-48-18	48	1219

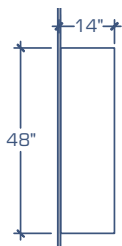

14" depth units



18" depth units

Reverse models are also available by adding "RV" to model number.

84" High Tall Cabinets

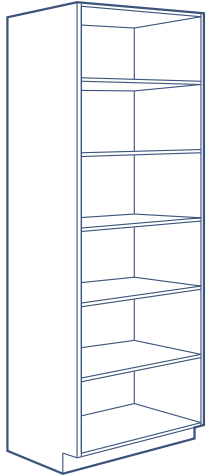

Open shelf tall cab

Model no.	Width	
	inches	mm
FO-85-15-14	15	381
FO-85-18-14	18	457
FO-85-21-14	21	533
FO-85-24-14	24	610
FO-85-30-14	30	762
FO-85-36-14	36	914
FO-85-42-14	42	1067
FO-85-48-14	48	1219
FO-85-15-18	15	381
FO-85-18-18	18	457
FO-85-21-18	21	533
FO-85-24-18	24	610
FO-85-30-18	30	762
FO-85-36-18	36	914
FO-85-42-18	42	1067
FO-85-48-18	48	1219
FO-85-15-22	15	381
FO-85-18-22	18	457
FO-85-21-22	21	533
FO-85-24-22	24	610
FO-85-30-22	30	762
FO-85-36-22	36	914
FO-85-42-22	42	1067
FO-85-48-22	48	1219

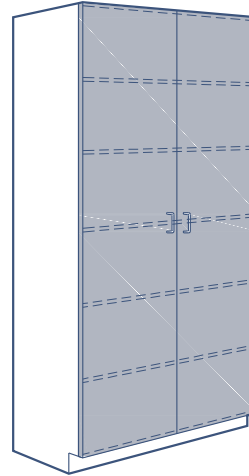

Model no.	Width	
	inches	mm
FO-86-30-14	30	762
FO-86-36-14	36	914
FO-86-42-14	42	1067
FO-86-48-14	48	1219
FO-86-30-18	30	762
FO-86-36-18	36	914
FO-86-42-18	42	1067
FO-86-48-18	48	1219
FO-86-30-22	30	762
FO-86-36-22	36	914
FO-86-42-22	42	1067
FO-86-48-22	48	1219

2 hinged door tall cab

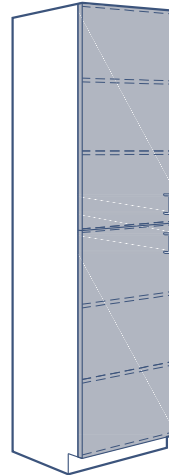

FO-86A-15-14	15	381
FO-86A-18-14	18	457
FO-86A-21-14	21	533
FO-86A-24-14	24	610
FO-86A-15-18	15	381
FO-86A-18-18	18	457
FO-86A-21-18	21	533
FO-86A-24-18	24	610
FO-86A-15-22	15	381
FO-86A-18-22	18	457
FO-86A-21-22	21	533
FO-86A-24-22	24	610

2 hinged door tall cab

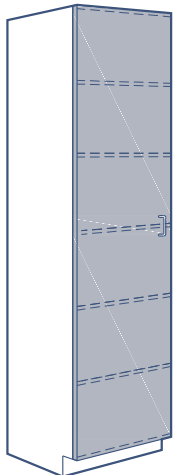

FO-86-15-14	15	381
FO-86-18-14	18	457
FO-86-21-14	21	533
FO-86-24-14	24	610
FO-86-15-18	15	381
FO-86-18-18	18	457
FO-86-21-18	21	533
FO-86-24-18	24	610
FO-86-15-22	15	381
FO-86-18-22	18	457
FO-86-21-22	21	533
FO-86-24-22	24	610

1 hinged door tall cab

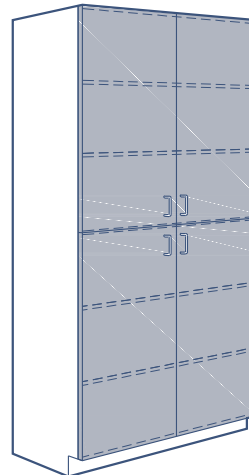

FO-86A-30-14	30	762
FO-86A-36-14	36	914
FO-86A-42-14	42	1067
FO-86A-48-14	48	1219
FO-86A-30-18	30	762
FO-86A-36-18	36	914
FO-86A-42-18	42	1067
FO-86A-48-18	48	1219
FO-86A-30-22	30	762
FO-86A-36-22	36	914
FO-86A-42-22	42	1067
FO-86A-48-22	48	1219

4 hinged door tall cab

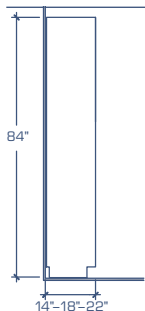

Tall cabinet available depths of 14", 18" and 22"



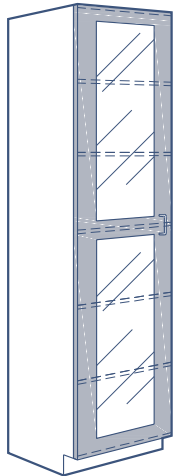

Model no.	Width	
	inches	mm
FO-87-15-14	15	381
FO-87-18-14	18	457
FO-87-21-14	21	533
FO-87-24-14	24	610
FO-87-15-18	15	381
FO-87-18-18	18	457
FO-87-21-18	21	533
FO-87-24-18	24	610
FO-87-15-22	15	381
FO-87-18-22	18	457
FO-87-21-22	21	533
FO-87-24-22	24	610

1 glazed hinged door tall cab

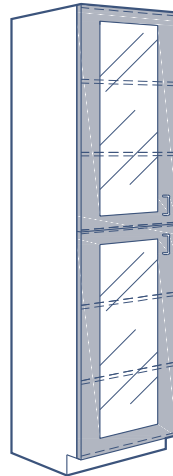

Model no.	Width	
	inches	mm
FO-87A-15-14	15	381
FO-87A-18-14	18	457
FO-87A-21-14	21	533
FO-87A-24-14	24	610
FO-87A-15-18	15	381
FO-87A-18-18	18	457
FO-87A-21-18	21	533
FO-87A-24-18	24	610
FO-87A-15-22	15	381
FO-87A-18-22	18	457
FO-87A-21-22	21	533
FO-87A-24-22	24	610

2 glazed hinged door tall cab

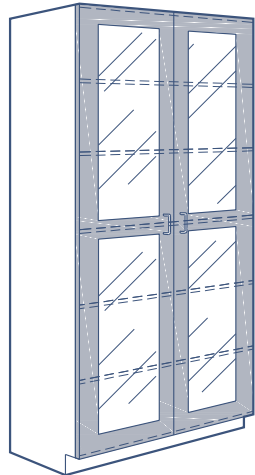

FO-87-30-14	30	762
FO-87-36-14	36	914
FO-87-42-14	42	1067
FO-87-48-14	48	1219
FO-87-30-18	30	762
FO-87-36-18	36	914
FO-87-42-18	42	1067
FO-87-48-18	48	1219
FO-87-30-22	30	762
FO-87-36-22	36	914
FO-87-42-22	42	1067
FO-87-48-22	48	1219

2 glazed hinged door tall cab

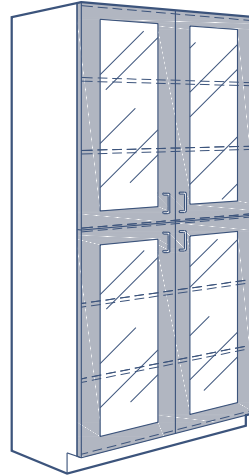

FO-87A-30-14	30	762
FO-87A-36-14	36	914
FO-87A-42-14	42	1067
FO-87A-48-14	48	1219
FO-87A-30-18	30	762
FO-87A-36-18	36	914
FO-87A-42-18	42	1067
FO-87A-48-18	48	1219
FO-87A-30-22	30	762
FO-87A-36-22	36	914
FO-87A-42-22	42	1067
FO-87A-48-22	48	1219

4 glazed hinged door tall cab

**Description**

- Framed glass doors to be supplied using 3 mm float glass



Tall cabinet: available depths of 14", 18" and 22"

**1 CABINET PULLS**

**Standard — Brushed nickel wire pull 4" c/c**

- WP  Stainless steel wire pull 4" c/c
- PP  Black recessed 4" x 2" pull
- AP  Aluminum recessed 4" x 2" pull

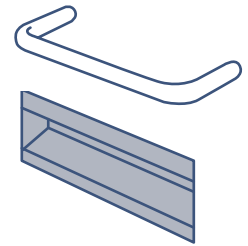

**2 DRAWER SLIDE ARMS**

**Standard — 75% opening self closing slide arms on all regular drawers – SEFA 8M – 150 lbs**

**Standard — 100% full extension opening on file drawers – SEFA 8M – 100 lbs**

**Standard — 100% full extension opening on all drawers larger than 36" – SEFA 8M – 100 lbs**

- TZ  100% full extension opening on all project drawers – SEFA 8M – 100 lbs
- TY  100% full extension opening with self closing option on all project drawers – SEFA 8M – 100 lbs
- TX  100% full extension opening on all project drawers – SEFA 8M – 200 lbs

**3 CABINET HINGES**

**Standard — knuckles nickel plated finish**

- FH  5-knuckles stainless steel finish
- MH  Polyamide mounted nickel plated steel MB-20

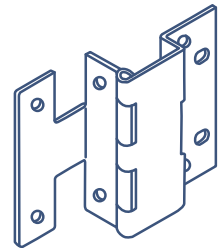

**4 LOCKS**

**Standard — None**

- KA  8-disc chrome plated with removable core on all doors and all drawers
- KT  8-disc chrome plated with removable core on all drawers
- KP  8-disc chrome plated with removable core on all doors and drawers
- K1  8-disc chrome plated with removable core on top drawers only
- KF  8-disc chrome plated with removable core on file drawers only
- KC  Chrome plated padlock bracket on all doors and all drawers
- XI  Interlocking system that permits only one drawer opening at the time (with full extension arms only) – standard on mobile cabinets
- TP  Theft security panels between drawers
  
- L1  All locks different with a project master key
- L2  All locks the same per cabinet with a project master key
- L3  All locks the same per room with a room master key

**5 DOOR CATCHES**

**Standard — Spring loaded roller door catch**



**6 CARD HOLDERS**

**Standard — None**

- CH  Aluminum 4" x 2" card holder on all drawers
- CD  Aluminum 4" x 2" card holder on all doors

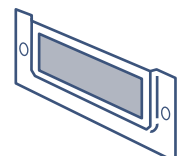

## 7 CABINET SHELF

**Standard — One (1) full depth shelf, adjustable on ½" increment**

- T1  Additional shelf per cabinet
- P1  Pull out shelf for cabinets 15", 18", 21" or 24" only
- PR  Pull out shelf on right cabinet side
- PL  Pull out shelf on left cabinet side
- S2  Split shelves (2 pieces), adjustable on ½" increment
- FS  Cabinet full extension shelf supplied with full extension slide arms – 200 lbs

## 8 FINISHED PANELS

**Standard — Removable access panel on cupboard cabinets only (open back on drawer cab)**

- BP  Removable access panel on drawer units
- FO  Painted steel flat finished back welded to cabinet
- FT  Painted steel flat finished top panel welded to cabinet

## 9 CABINET BASE OPTIONS

**Standard — 3" x 4" high integral front toe kick with four 3/8"x 2 1/2" leveler glides**

- PN  Cabinet levelers supplied with grey rubber cap
- SS  Four swivel casters 4" height, rubber, with brakes on two front casters – 275 lbs
- WB  Cabinet supplied with no toe kick (4" shorter)
- RT  Cabinet supplied with a right toe kick 3" x 4" high – not available on tall cabinets
- LT  Cabinet supplied with a left toe kick 3" x 4" high – not available on tall cabinets
- VT  Cabinet supplied with a venting grill on the front toe kick

## 10 VARIOUS OTHER CABINET OPTIONS

- RV  Reverse door/drawer arrangement
- SK  Sink support consisting on 2 horizontal struts with 4 rod hangers
- LG  6mm Laminated glass in lieu of standard 3mm float glass
- TG  6mm Tempered glass in lieu of standard 3mm float glass
- SB  Stainless steel bin insert into bin cabinets
- GB  Galvanized bin insert into bin cabinets
- LP  Leak proof bin insert into bin cabinets
- WC  Grill(s) incorporated into cabinet door(s)
- SS4  Same cabinet but supplied in stainless steel T.304
- SS6  Same cabinet but supplied in stainless steel T.316
- AC  Self closing doors(s) option to flammable cabinets



**BEDCOLAB LTD**

**2305, Francis-Hugues Avenue  
Laval, Quebec, Canada H7S 1N5**

**Phone: 514.384.2820 / 1.800.461.6414**

**Fax: 514.384.9210**

**E-mail: [information@bedcolab.com](mailto:information@bedcolab.com)**

**Web Site: [www.bedcolab.com](http://www.bedcolab.com)**



**Authorized dealer:**